

# AMPLIFI™

HOME WI-FI MESH TECHNOLOGY™



## AmpliFi™ Home Wi-Fi System

Models: AFi, AFi-LR, AFi-HD

Turbocharged 802.11ac Wi-Fi

Complete Home Wi-Fi System

Perfected User Experience



## Not Just a Wi-Fi Router, It's a Wi-Fi System

AmpliFi is more than a common home router: it's the ultimate Wi-Fi system. With turbocharged 802.11AC Wi-Fi, AmpliFi utilizes multiple self-configuring radios and advanced antenna technology to bring ubiquitous Wi-Fi coverage to any home.

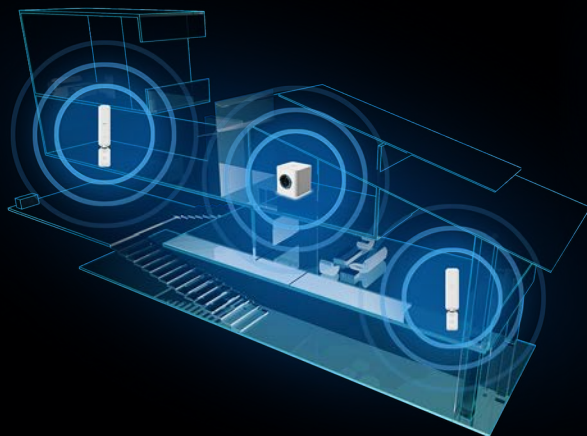

Best Performance

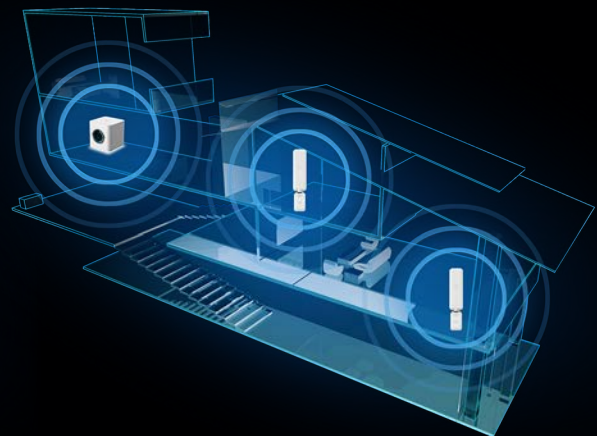

Mesh Multi-Hop

# Your Wi-Fi Router is No Longer Something to Hide

Designed from the outside in, AmpliFi is meant to be a showcase piece for the modern home.



## Perfected User Experience

One intuitive app allows instant setup, powerful reporting metrics, and easy guest access. Out of the box, the AmpliFi Router and Mesh Points are pre-paired to work seamlessly as a Wi-Fi system. The smart touchscreen display combined with the Bluetooth capabilities of the router provide an instant setup experience using any Android or iOS smartphone.



# AMPLIFI™

## System Overview

The AmpliFi Home Wi-Fi System includes a Router and two Mesh Points for Wi-Fi coverage throughout your home. The AmpliFi Wi-Fi System uses mesh technology to provide powerful wireless performance in an innovative and simple design. The Router features an intuitive touchscreen display and the Mesh Points display wireless signal performance.



## System Comparison Chart



	AMPLIFI™	AMPLIFI™ LR	AMPLIFI™ HD
Model	AFi	AFi-LR	AFi-HD
Range	10,000 sq. ft	20,000 sq. ft	20,000 sq. ft
Speed	2.35 Gbps	2.35 Gbps	5.25 Gbps
Max. TX Power	24 dBm	26 dBm	26 dBm
Radios	4	4	6
MIMO Chains	10	10	18
	<b>GREAT</b>	<b>BETTER</b>	<b>BEST</b>

### Router

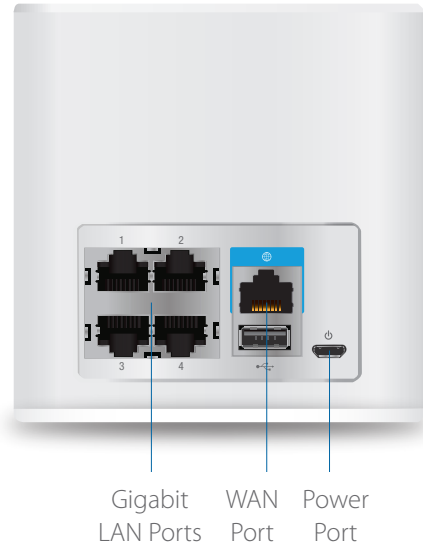
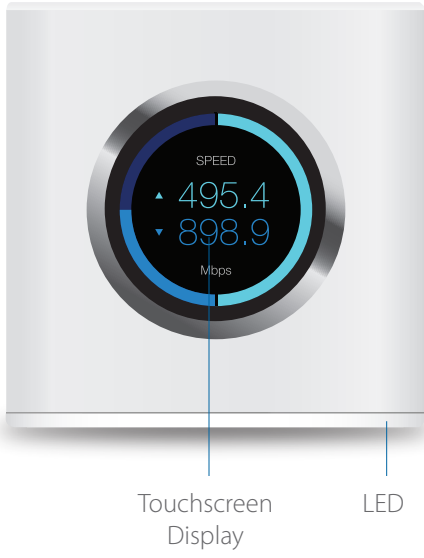

### Two Mesh Points

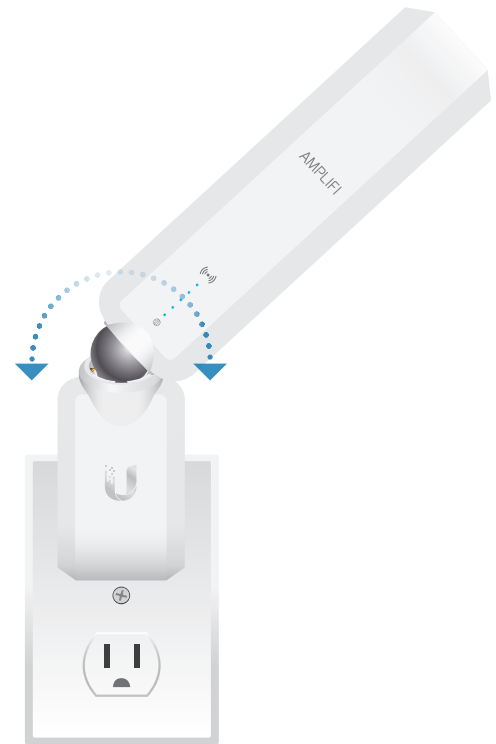
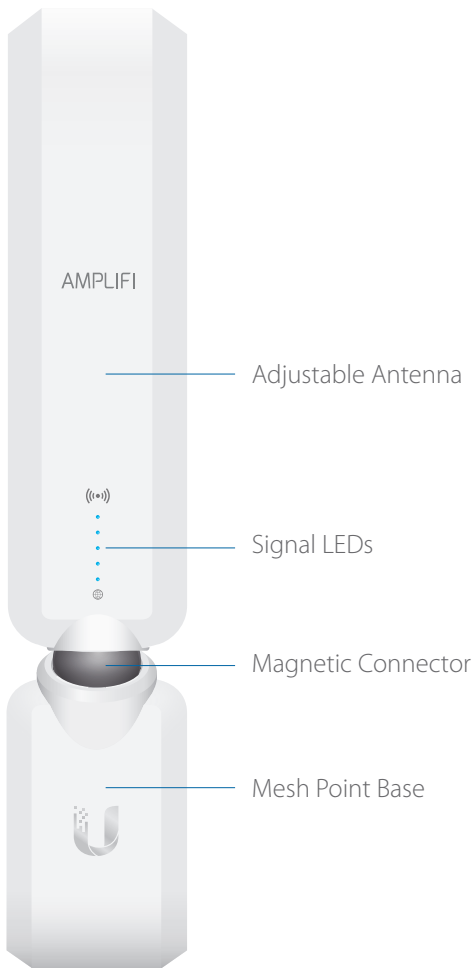

Adjust the Antenna for optimal signal reception





# System Specifications

Model	Standard	LR	HD
Max. TX Power	24 dBm	26 dBm	26 dBm
Radios	4	4	6
MIMO Chains	10	10	18
Speed	2.35 Gbps	2.35 Gbps	5.25 Gbps
Range	10,000 sq. ft	20,000 sq. ft	20,000 sq. ft

Common Specifications	
Networking Interface	Wi-Fi/Gigabit Ethernet (1) WAN, (4) LAN
Max. Power Consumption	11W
ESD/EMP Protection	± 24kV Air/Contact
Buttons	Reset
Antennas	(3) Dual-Band Antennas
Display	1.6" (40.6 mm) Diagonal, 240 x 240, 212 ppi, G+F Touch, Full Color
Wi-Fi Standards	802.11ac
Power Save	Supported
Wireless Security	WPA2-PSK AES/TKIP
Operating Temperature	14 to 131° F (-10 to 55° C)
Operating Humidity	5 to 95% Noncondensing
Certifications	FCC / CE / IC

Supported Data Rates (Mbps)	
802.11ac	13 Mbps to 1300 Mbps (MCS0 - MCS9, VHT 20/40/80)
802.11n	6.5 Mbps to 450 Mbps (MCS0 - MCS23, HT 20/40)
802.11a	6, 9, 12, 18, 24, 36, 48, 54 Mbps
802.11b	1, 2, 5.5, 11 Mbps
802.11g	6, 9, 12, 18, 24, 36, 48, 54 Mbps



## Wireless, Boosted

The AmpliFi System includes two Mesh Points, and you can add more if needed. The Mesh Points fit discreetly in any household, wherever dead spots need coverage. Signal strength LEDs are integrated into the design to ensure the system is positioned for optimal performance.





## Guest Access Simplified

AmpliFi utilizes an *open time window* concept to allow instant guest access without the security compromise and inconvenience of password sharing.



### 24/7 Live Global Chat Support

24/7 Live Global Chat Support within the AmpliFi app and also online at [help.amplifi.com](http://help.amplifi.com)



L A B S

**AMPLIFI™**  
[www.amplifi.com](http://www.amplifi.com)

Specifications are subject to change. Ubiquiti products are sold with a limited warranty described at: [www.ubnt.com/support/warranty](http://www.ubnt.com/support/warranty)  
©2016 Ubiquiti Networks, Inc. All rights reserved. Ubiquiti, Ubiquiti Networks, the Ubiquiti U logo, ULabs, the ULabs logo, AmpliFi, and Home Wi-Fi Mesh Technology are trademarks or registered trademarks of Ubiquiti Networks, Inc. in the United States and in other countries. Apple, the Apple logo, and iPhone are trademarks of Apple Inc., registered in the U.S. and other countries. App Store is a service mark of Apple Inc. Android, Google, Google Play, the Google Play logo and other marks are trademarks of Google Inc. All other trademarks are the property of their respective owners.